

- Back**
- o PushPull Power
  - o Flat Cable Connectors SEK
  - o *har-mik®*
  - o D-Sub
  - o InduCom

---

- **Applications**

---

## Product details

---

**09 03 196 6922**

### Printed board connector

Type	Type C
Standard/Inverse	Standard
Contact gender	Male contacts
Size	Whole size
Number of contacts	96 poles
Contact arrangement	Rows a, b and c
Termination	Straight solder pins
Termination length	3.0 mm
First mating contact	without first mating contacts
Performance Class	Performance level 2 as per IEC 60603-2
Contacts	with contacts
Row pitch	2.54 mm
Current	2 A max.
Clearance/ Creepage	1.2 / 1.2 mm min.
RoHS compliant	Yes

**Inquiry**

Alle Rechte vorbehalten/ All rights reserved

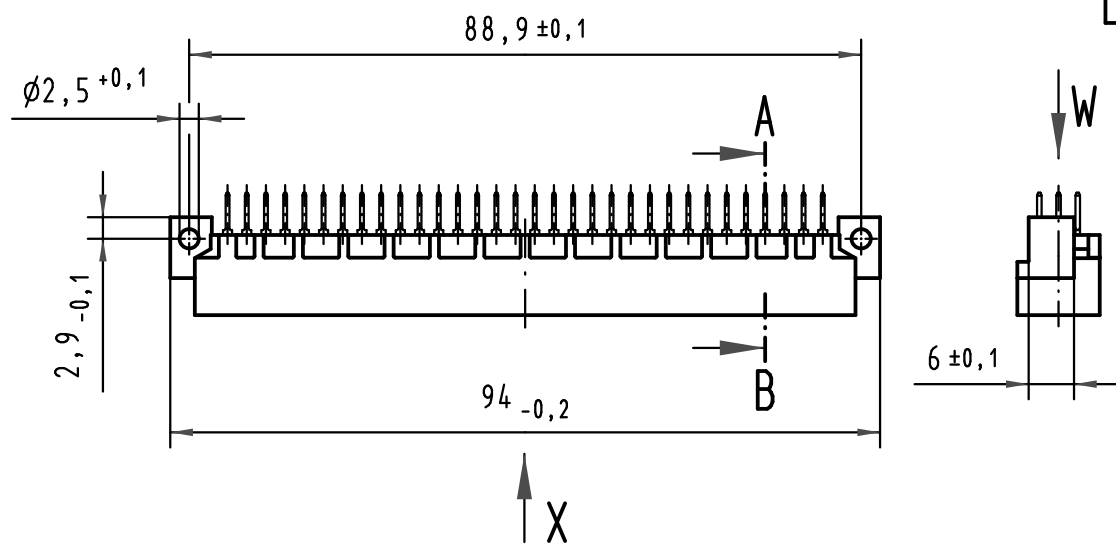
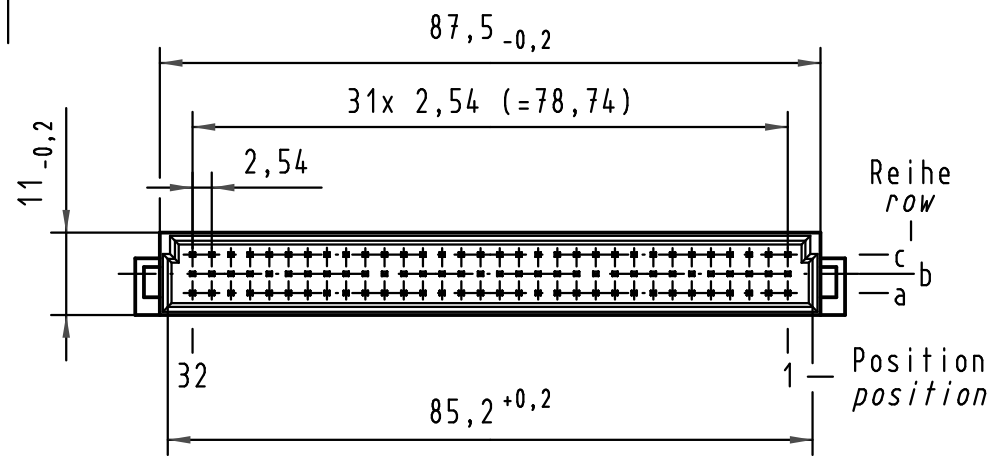
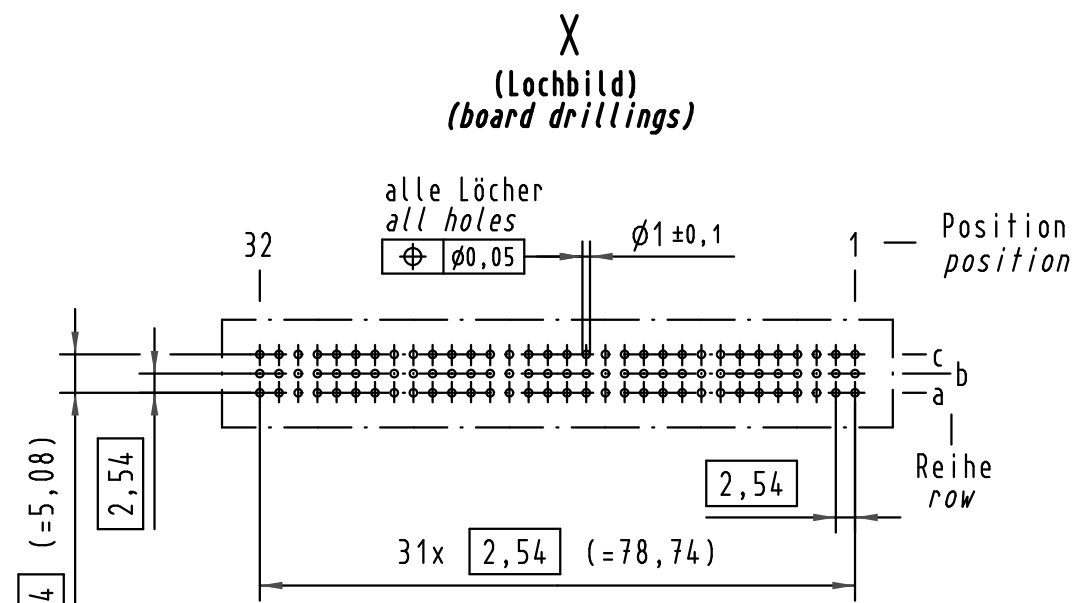

**W**  
10:1  
Querschnitt der  
Lötanschlüsse:  
cross-section of  
solder terminations:

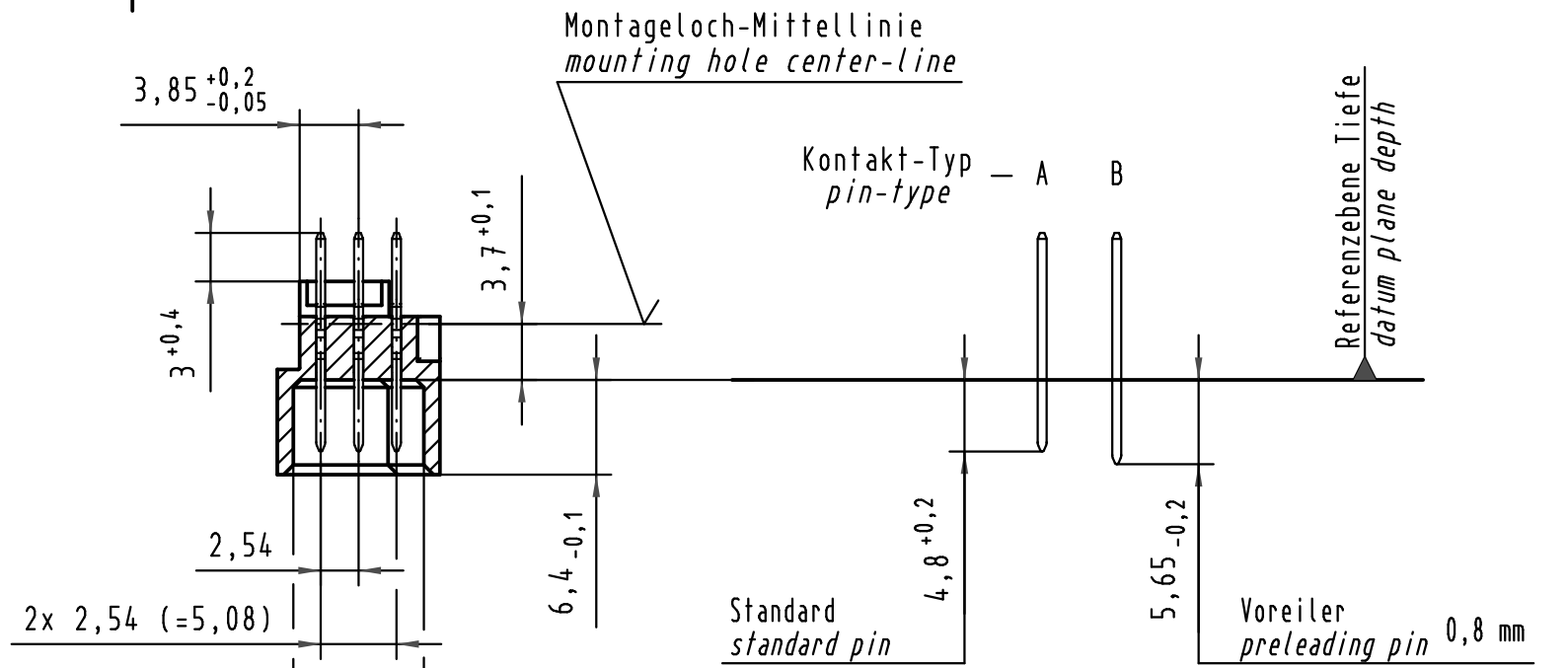
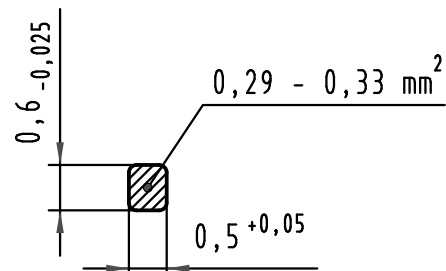

A-B  
2:1

**X** Kontaktbelegung  
contact loading

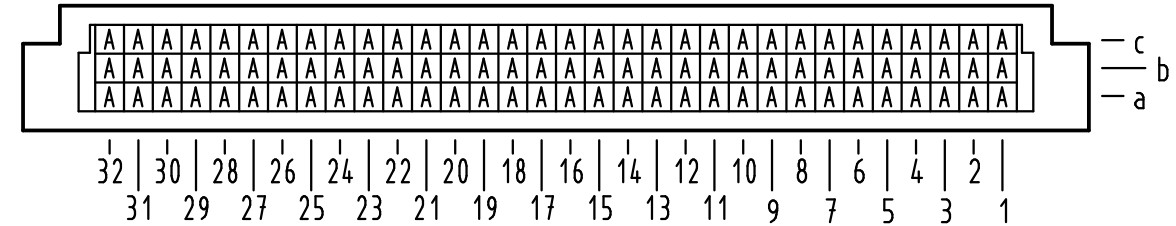

09 03 196 7922	3	Au über/over Ni
09 03 196 6922	2	Au über/over Ni
09 03 196 2922	1	Au über/over Ni
Bestell-Nr. part-no.	Anforderungsstufe nach IEC performance level acc. to IEC	Kontaktoberfläche contact plating



Techn. Character.		
	Dat.	Name
	03.07.00	Rie.
	03.07.00	Pa.

Nicht tolerierte Maße/Free size tolerances  
IEC 60603-2

Bauform C Messerleiste  
Einlöt, 96 pol.  
type C male connector  
solder, 96 pol.

34650	18.10.07	Hage.
27486		
Mod.	Dat.	Name

HARTING Electronics GmbH & Co. KG  
D-32339 ESPELKAMP

TB 09 03 196 x922

Blatt/page